

TELAIETTO LATERALE SPECIFICO - SPECIFIC SADDLEBAG TUBULAR HOLDER  
 SUPPORT TUBULAIRE POUR SACOCHES CAVALIÈRES - SPEZIAL SEITENTRÄGER FUER WEICHTASCHEN  
 PORTA ALFORJAS TUBULAR LATERAL

# APRILIA SHIVER 750 07/08

ISTRUZIONI DI MONTAGGIO - MOUNTING INSTRUCTIONS  
 INSTRUCTIONS DE MONTAGE - BAUANLEITUNG - INSTRUCCIONES DE MONTAJE

①

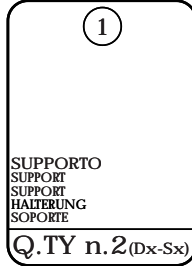

SUPPORTO  
SUPPORT  
SUPPORT  
HALTERUNG  
SOPORTE

Q.TY n.2 (Dx-Sx)

②



DADO A.B. M5  
BOIT M5  
ECROU M5  
MUTTER M5  
TUERCA M5

Q.TY n.2

③

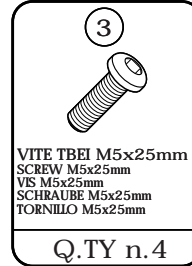

VITE TBEI M5x25mm  
SCREW M5x25mm  
VIS M5x25mm  
SCHRAUBE M5x25mm  
TORNILLO M5x25mm

Q.TY n.4

④

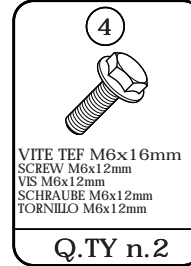

VITE TEF M6x16mm  
SCREW M6x12mm  
VIS M6x12mm  
SCHRAUBE M6x12mm  
TORNILLO M6x12mm

Q.TY n.2

⑤



DISTANZIALE Ø16x3mm  
Foro 6,5mm, V263  
SPACER  
ENTRETOISE  
DISTANZSTUECK  
DISTANCIADOR

Q.TY n.2

⑥



DISTANZIALE Ø14x5,5mm  
Ribassato Ø8x4mm  
V064  
SPACER  
ENTRETOISE  
DISTANZSTUECK  
DISTANCIADOR

Q.TY n.4

⑦

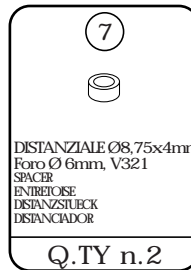

DISTANZIALE Ø8,75x4mm  
Foro Ø 6mm, V321  
SPACER  
ENTRETOISE  
DISTANZSTUECK  
DISTANCIADOR

Q.TY n.2

⑧

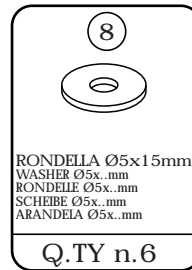

RONDELLA Ø5x15mm  
WASHER Ø5x..mm  
RONDELLE Ø5x..mm  
SCHEIBE Ø5x..mm  
ARANDELA Ø5x..mm

Q.TY n.6

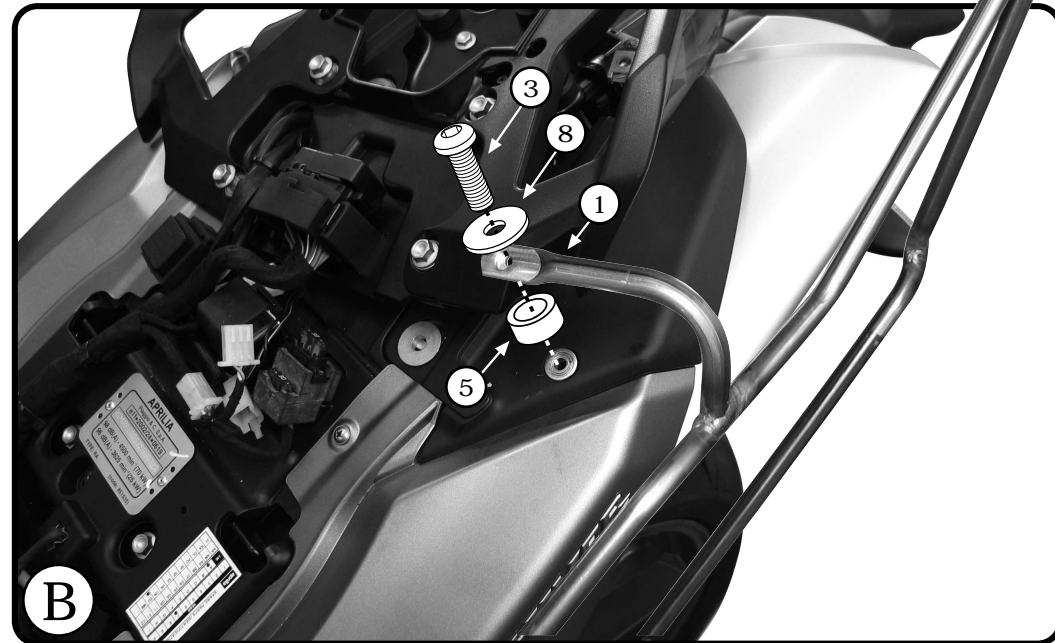
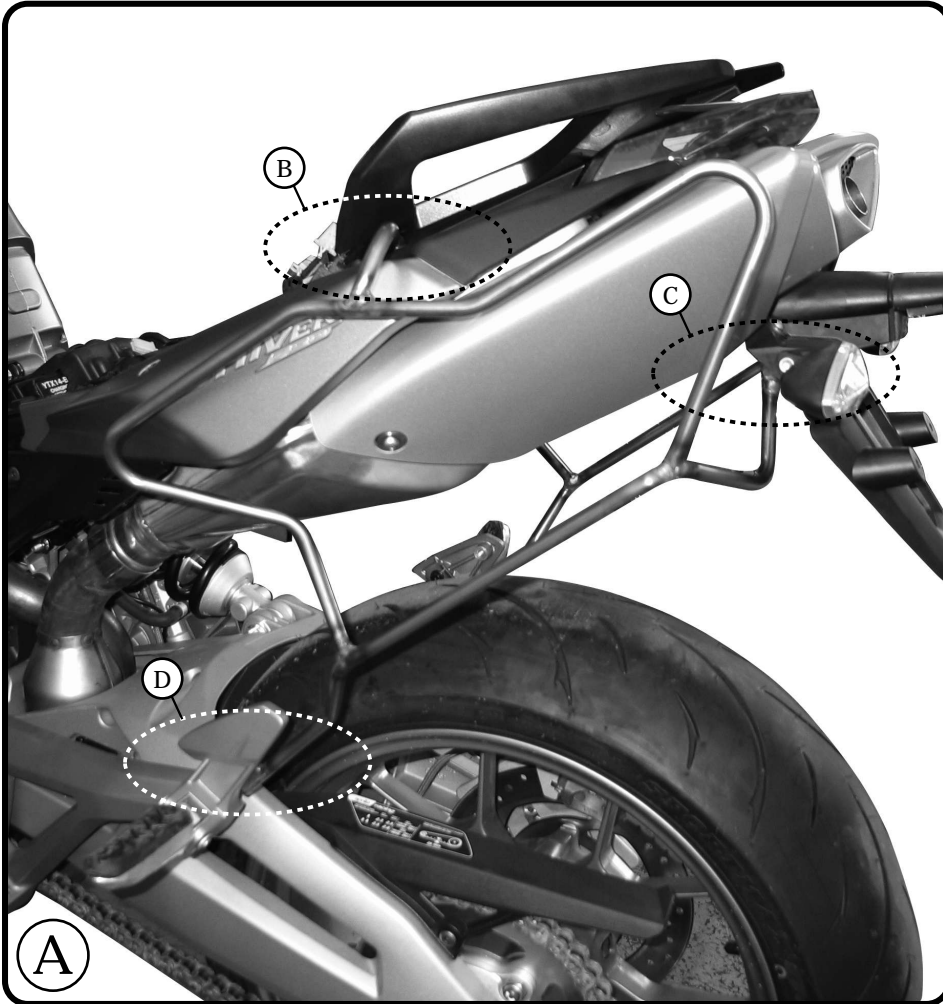

T770 - T770K

TELAIETTO LATERALE SPECIFICO - SPECIFIC SADDLEBAG TUBULAR HOLDER  
SUPPORT TUBULAIRE POUR SACOCHES CAVALIÈRES - SPEZIAL SEITENTRÄGER FÜR WEICHTASCHEN  
PORTA ALFORJAS TUBULAR LATERAL

# APRILIA SHIVER 750 07/08

ISTRUZIONI DI MONTAGGIO - MOUNTING INSTRUCTIONS  
INSTRUCTIONS DE MONTAGE - BAUANLEITUNG - INSTRUCCIONES DE MONTAJE

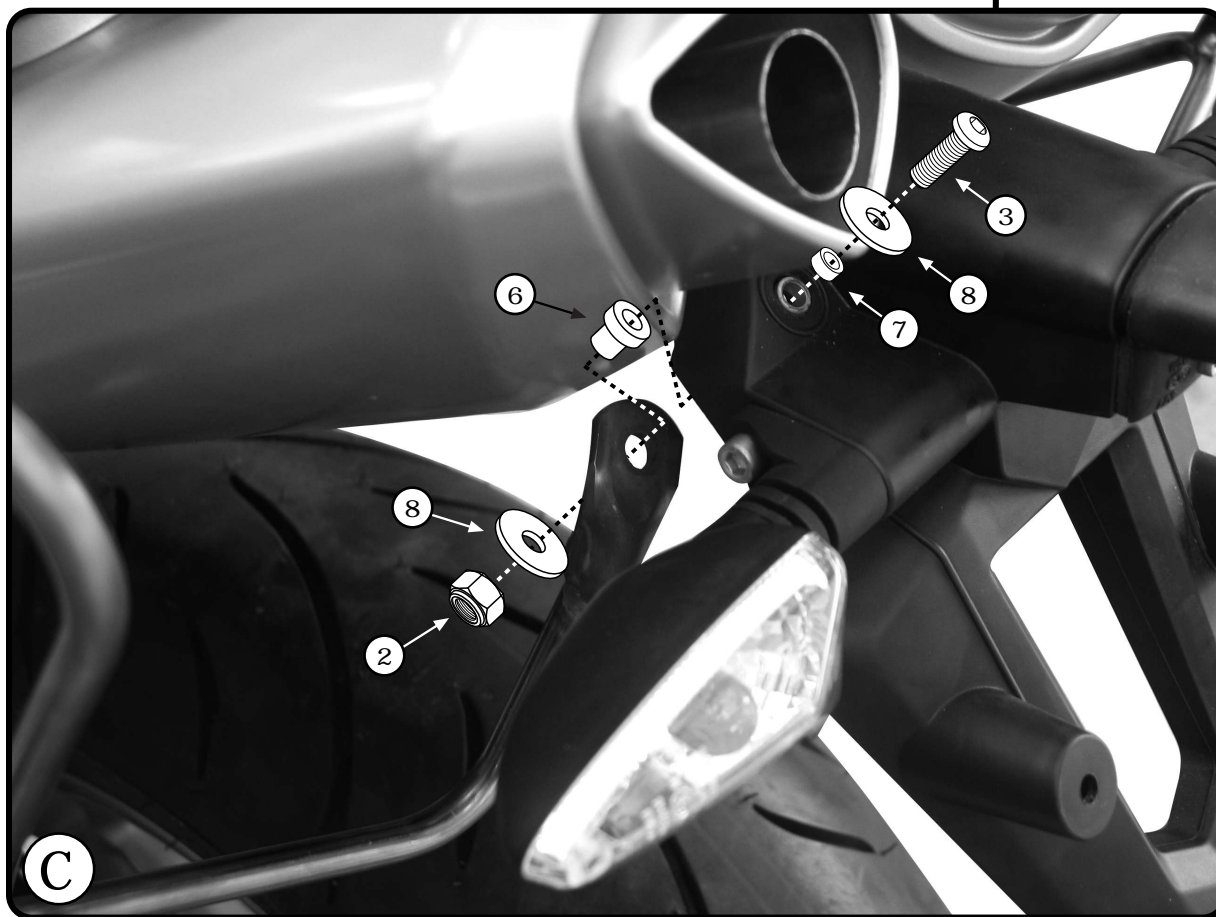
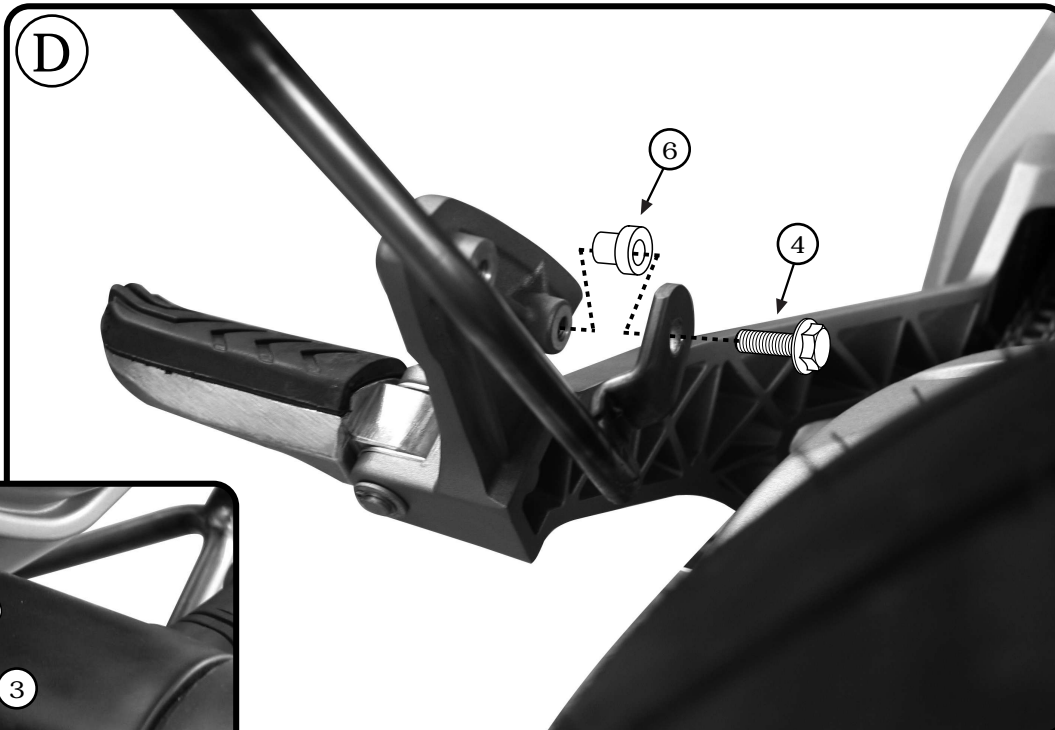

TELAJETTO LATERALE SPECIFICO - SPECIFIC SADDLEBAG TUBULAR HOLDER  
SUPPORT TUBULAIRE POUR SACOCHES CAVALIÈRES - SPEZIAL SEITENTRAEGER FUER WEICHTASCHEN  
PORTA ALFORJAS TUBULAR LATERAL

# APRILIA SHIVER 750 07/08

ISTRUZIONI DI MONTAGGIO - MOUNTING INSTRUCTIONS  
INSTRUCTIONS DE MONTAGE - BAUANLEITUNG - INSTRUCCIONES DE MONTAJE

## I ISTRUZIONI DI MONTAGGIO

- SVITARE LE VITI CHE FISSANO IL MANIGLIONE ORIGINALE DELLA MOTO E POSIZIONARE IL TELAIETTO COME INDICATO IN FIGURA "B".
- FISSARE IL TELAIETTO AL PORTATARGA (FIGURA "C") (TOGLIERE LA CIP ORIGINALE FILETTATA) E SUCCESSIVAMENTE ALLE PEDALINE COME INDICATO IN FIGURA "D".

## GB MOUNTING INSTRUCTIONS

1. REMOVE THE SCREWS FROM THE ORIGINAL BRACKET. POSITION AND INSTALL THE SUPPORT AS SEEN ON PICTURE B.
2. ATTACH THE UPPER REAR MOUNT TO THE TAG SUPPORT PLATE AS SHOWN IN PICTURE C AND THEN TO THE FOOT PEG AS SHOWN IN PICTURE D.

## F INSTRUCTIONS DE MONTAGE

1. DEVISSER LES VIS QUI FIXENT LA POIGNEE D'ORIGINE DE LA MOTO ET POSITIONNER LE PORTE-VALISE COMME INDIQUE EN PHOTO "B".
2. FIXER LES SUPORT-SACOCHE AU SUPPORT DE PLAQUE (PHOTO "C") ET ENSUITE AUX PLATINES DE REPOSE-PIEDS PASSAGER COMME INDIQUE EN PHOTO "D".

## D BAUANLEITUNG

1. LÖSEN SIE DIE SCHRAUBEN, DIE BEIM ORIGINALHANDGRIFF DES MOTORRADS BEFESTIGT SIND. POSITIONIEREN SIE DIE HALTERUNG WIE IM BILD B GEZEIGT.
2. BEFESTIGEN SIE DIE HALTERUNG AM NUMMERNSCHILDHALTER (BILD C) UND ANSCHLIEBEND AN DEN FUßRASTEN WIE IM BILD D DARGESTELLT.

## ES

## INSTRUCCIONES DE MONTAJE

1. DESATORNILLAR LOS TORNILLOS QUE FIJAN EL ASIDERO ORIGINAL DE LA MOTO Y POSICIONAR EL PEQUEÑO CHASIS SEGÚN LO INDICADO EN LA FIGURA "B".
2. FIJAR EL PEQUEÑO BASTIDOR AL PORTA-PLACA (FIGURA "C") Y SUCESIVAMENTE A LOS REPOSA-PIES CONFORME A LO INDICADO EN LA FIGURA "D"