

ATTACCHI SPECIFICI PER - SPECIFIC FITTING KIT FOR
 KIT DE MONTAGE SPECIFIQUE POUR - SPEZIFISCHER MONTAGEKIT FÜR
 ANCLAJE ESPECÍFICO PARA

DUCATI MONSTER 696

'08 - '09

ISTRUZIONI DI MONTAGGIO - MOUNTING INSTRUCTIONS
 INSTRUCCIONES DE MONTAJE - BAUANLEITUNG - INSTRUCCIONES DE MONTAJE

1

SUPPORTO
 SUPPORT
 SUPPORT
 HALTERUNG
 SOPORTE
Q.TY n.1

2

DISTANZIALE Ø12x12mm
 Foro Ø8,5mm, V446
 SPACER
 ENTRETOISE
 DISTANZSTÜCK
 DISTANCIADOR
Q.TY n.2

3

DISTANZIALE Ø12x9mm
 Foro Ø8,5mm, V729
 SPACER
 ENTRETOISE
 DISTANZSTÜCK
 DISTANCIADOR
Q.TY n.2

4

VITE TBEI M8x45mm
 SCREW
 VIS
 SCHRAUBE
 TORNILLO
Q.TY n.4

5

VITE TSCEI M6x20mm
 SCREW
 VIS
 SCHRAUBE
 TORNILLO
Q.TY n.4

6

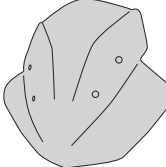
RONDELLA SVASATA Ø6mm
 200RON
 WASHER Ø6mm
 RONDELLE Ø6mm
 SCHEIBE Ø6mm
 ARANDELA VACIADA Ø6mm
Q.TY n.4

7

RONDELLA IN GOMMA 16x2 Ø6
 RUBBER WASHER
 RONDELLE EN CAOUTCHOUC
 GUMMI SCHEIBE
 ARANDELA DE GOMA
Q.TY n.8

8

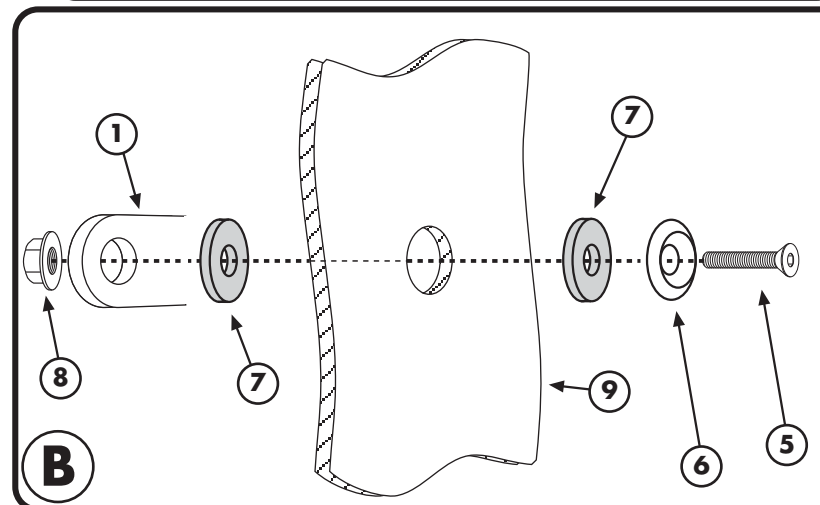
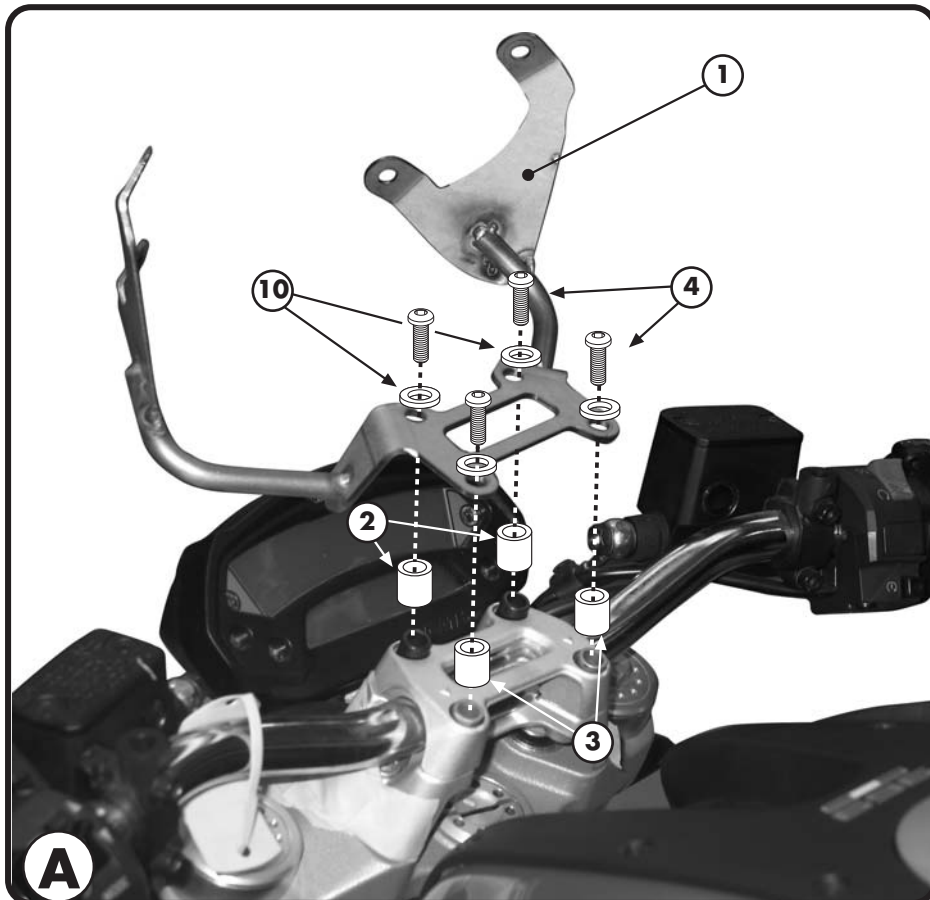
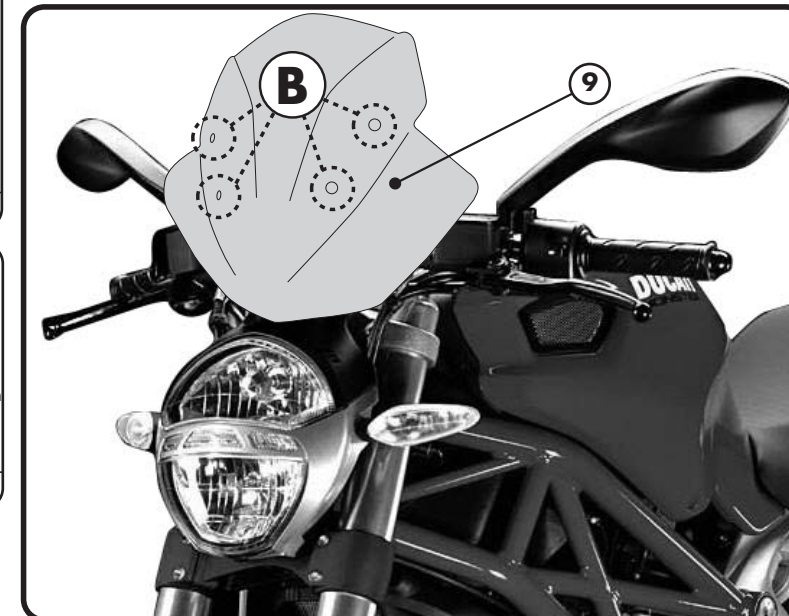
DADO A.B. M6
 FLANGIATO
 BOLT M6
 ECROU M6
 MUTTER M6
 TUERCA M6
Q.TY n.4

9

Q.TY n.1

10

RONDELLA Ø8x14mm
 WASHER Ø8x14mm
 RONDELLE Ø8x14mm
 SCHEIBE Ø8x14mm
 ARANDELA Ø8x14mm
Q.TY n.4



ATTACCHI SPECIFICI PER - SPECIFIC FITTING KIT FOR
KIT DE MONTAGE SPECIFIQUE POUR - SPEZIFISCHER MONTAGEKIT FÜR
ANCLAJE ESPECÍFICO PARA

DUCATI MONSTER 696

'08 - '09

ISTRUZIONI DI MONTAGGIO - MOUNTING INSTRUCTIONS
INSTRUCTIONS DE MONTAGE - BAUANLEITUNG - INSTRUCCIONES DE MONTAJE

I ISTRUZIONI DI MONTAGGIO

1. MONTARE IL SUPPORTO NUMERO 1 COME INDICATO IN FIGURA A;
2. FISSARE IL CUPOLINO SEGUENDO IL PROCEDIMENTO DI FIGURA B;
3. ULTIMARE IL MONTAGGIO VERIFICANDO CHE TUTTE LE VITI SIANO SERRATE BENE (VITI M6=9,6Nm - VITI M8=23Nm).

GB MOUNTING INSTRUCTIONS

1. REMOVE THE BOLTS FROM THE HANDLEBAR RISERS.
2. PLACE THE WINDSCREEN SUPPORT (ITEM N°1) INTO POSITION AND INSTALL AS SHOWN IN PICTURE A;
3. ATTACH THE WINDSCREEN FOLLOWING THE PROCEEDURE SHOWN IN PICTURE AND FIGURE B;
4. MAKE SURE THAT ALL THE NUTS AND BOLTS ARE TIGHTENED APPROPRIATELY (BOLTS M6=9.6Nm - BOLTS M8=23Nm).

F INSTRUCTIONS DE MONTAGE

1. MONTER LE SUPPORT N°1, COMME INDIQUE EN PHOTO A;
2. FIXER LE PARE-BRISE EN SUIVANT LE PROCEDE EN PHOTO B;
3. TERMINER LE MONTAGE EN CONTROLANT LE BON SERRAGE DE TOUTES LES VIS (VIS M6=9,6Nm - VIS M8=23Nm).

D BAUANLEITUNG

1. MONTIEREN SIE DIE HALTERUNG NR. 1 WIE IM BILD A GEZEIGT;
2. MONTIEREN SIE DAS WINDSCHILD WIE BEI DER MONTAGE DES BILDES B HINGEWIESEN;
3. ZULETZT ÜBERPRÜFEN SIE DASS ALLE SCHRAUBEN (SCHRAUBEN M6=9,6NM - SCHRAUBEN M8=23NM) FESTGEZOGEN WURDEN.

ES INSTRUCCIONES DE MONTAJE

1. MONTAR EL SOPORTE NÚMERO 1 COMO MUESTRA LA ILUSTRACIÓN "A";
2. FIJAR LA CÚPULA SIGUIENDO EL PROCEDIMIENTO COMO SE MUESTRA EN LA ILUSTRACIÓN "B";
3. COMPLETAR EL MONTAJE VERIFICANDO QUE TODOS LOS TORNILLOS ESTEN BIEN APRETADOS (TORNILLOS M6=9,6NM - TORNILLOS M8=23NM).